

Project Name:	Type:
Part Number:	Date:

# PINFIT PL OMNI

## FEATURES

- Replaces 13W-26W CFL lamps
- DIRect or BYPass installation
- DIRect installation\* - Compatible with both electronic ballast (G24q/GX24q) and magnetic ballast (G24d/GX24d)
- BYPass installation - Work off line voltage (G24d/GX24d/G24q/GX24q)
- Patented modular socket design allows easy switching of the lamp socket from 4 pin mode for DIRect installation with electronic ballast to 2 pin mode for DIRect installation with magnetic ballast or BYPass installation without ballast in the field
- Embedded universal driver suitable for electronic ballast, magnetic ballast or no-ballast environments
- 9W models are 0-10V dimmable (ballast dependent)\*
- Omni directional light distribution equivalent to fluorescent lamps
- May be installed horizontally and vertically
- Exceptional high efficacy up to 128 LPW
- Lamp CCT falls within 4 SDCM for consistent CCT
- Suitable for damp locations and totally enclosed fixtures\*\*
- UL Listed and UL Classified
- Lamp ambient temperature: -4°F to 113°F (-20°C to 45°C)
- Fixture operating temperature: -4°F to 95°F (-20°C to 35°C)
- Rated lifetime (L70): 50,000hrs
- 5 year limited warranty\*\*\* / 10 year available (see EXTENDED WARRANTIES table for information)



120622



## FOCUS FEATURE

The revolutionary modular socket design of the PinFit PL Omni allows easy switch of the lamp socket from G24q to G24d in the field, offering great installation versatility. Simply use a screwdriver to pry open the buckle and remove the modular socket and the transformation from a 4 pins lamp to a 2 pins lamp is done.

**Step 1**  
Pry open the buckle

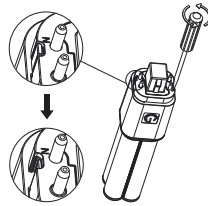

**Step 2**  
Remove the modular socket

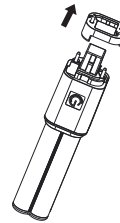

**Step 3**  
Lamp is transformed into 2 pins mode

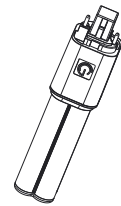

## SPECIFICATIONS

Product	Model	Equiv.	Lamp Base	Input Voltage	Wattage	Lumens	CCT	CRI	Efficacy (LPW)	Power Factor	THD	Beam Angle	Dim.*	Fixture Rating**
36732	6.8PLO/827/HYB/PF	13W-18W	G24q or G24d	120-277V	6.8	720	2700K	82	106	0.9	<20%	360°	No	Enclosed
36733	6.8PLO/830/HYB/PF	13W-18W	G24q or G24d	120-277V	6.8	740	3000K	82	109	0.9	<20%	360°	No	Enclosed
36734	6.8PLO/835/HYB/PF	13W-18W	G24q or G24d	120-277V	6.8	800	3500K	82	118	0.9	<20%	360°	No	Enclosed
36735	6.8PLO/840/HYB/PF	13W-18W	G24q or G24d	120-277V	6.8	800	4000K	82	118	0.9	<20%	360°	No	Enclosed
36736	9PLO/827/HYB/PF	26W	G24q or G24d	120-277V	9	1,050	2700K	82	117	0.9	<20%	360°	Yes	Enclosed
36737	9PLO/830/HYB/PF	26W	G24q or G24d	120-277V	9	1,100	3000K	82	122	0.9	<20%	360°	Yes	Enclosed
36738	9PLO/835/HYB/PF	26W	G24q or G24d	120-277V	9	1,150	3500K	82	128	0.9	<20%	360°	Yes	Enclosed
36739	9PLO/840/HYB/PF	26W	G24q or G24d	120-277V	9	1,150	4000K	82	128	0.9	<20%	360°	Yes	Enclosed

\* Ballast Dependent. Please refer to [www.greencreative.com](http://www.greencreative.com) for full ballast and dimmer compatibility list.

\*\* Suitable for use in totally enclosed fixtures. Please make sure the minimum dimensions of the lamp compartment in the fixture meet the guidelines in the installation guide.



# PINFIT PL OMNI

## DIMENSION & WEIGHT

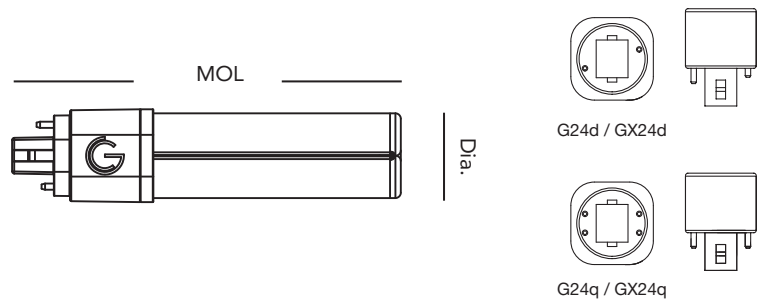

Model	6.8PLO/xxx/HYB/PF	9PLO/xxx/HYB/PF
Compatible base	G24d, GX24d, G24q & GX24q	
MOL	5-11/16"	6-7/8"
Dia.	1-3/8"	1-3/8"
Weight	0.18 lb	0.22 lb

Where xxx means 824-965 which indicates CRI and color temperature

## MINIMUM COMPARTMENT DIMENSIONS

Note – the base of this lamp is 1-3/8" by 1-3/8" and the opening in the reflector should be a minimum of 1-3/8" by 1-3/8" to insure a proper fit. For non-enclosed rated applications the minimum compartment must follow the below guidelines.

Non-enclosed Fixture Horizontal Installation 	Model Number		6.8PLO/xxx/HYB/PF	9PLO/xxx/HYB/PF
	Lamp Compartment Dimensions	Diameter	6-1/8"	6-1/8"
		Height	4-3/4"	4-3/4"
	Maximum Lamps in Luminaire		2	2
Lampholder-to-Lampholder Spacing		3/8"	3/8"	

Non-enclosed Fixture Vertical Installation 	Model Number		6.8PLO/xxx/HYB/PF	9PLO/xxx/HYB/PF
	Lamp Compartment Dimensions	Diameter	4-1/2"	6-5/16"
		Height	8-1/16"	9-1/16"
	Maximum Lamps in Luminaire		1	1

For enclosed rated applications the minimum compartment must follow the below guidelines.

Wall Mounted Enclosed Fixture Installation 	Model Number		6.8PLO/xxx/HYB/PF	9PLO/xxx/HYB/PF
	Lamp Compartment Dimensions	Length	11-13/16"	11-13/16"
		Width	6-5/16"	6-5/16"
		Height	2-3/4"	2-3/4"
	Maximum Lamps in Luminaire		2	2
Lampholder-to-Lampholder Spacing		1-7/8"	1-7/8"	

Where xxx means 824-965 which indicates CRI and color temperature.

Product warranty is defined based on the condition of above minimum compartment size, maximum lamps in glass/metal luminaire.

## TEMPERATURE

Fixture operating temperature	Lamp ambient temperature		
 Non-enclosed Fixture	-4°F to 95°F (-20°C to 35°C)	 6.8PLO/xxx/HYB/PF	-4°F to 113°F (-20°C to 45°C)
 Wall Mounted Enclosed Fixture		 9PLO/xxx/HYB/PF	

Where xxx means 824-965 which indicates CRI and color temperature.

# PINFIT PL OMNI

## DIRECT INSTALLATION – ELECTRONIC BALLAST – DEFAULT 4 PIN MODE

When used with an electronic ballast, the PLO PinFit can function as a plug & play lamp and operate with the existing ballast at default 4 pin mode.

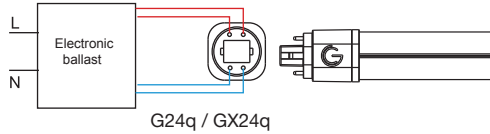

## DIRECT INSTALLATION – MAGNETIC BALLAST – 2 PIN MODE

When used with a magnetic ballast, the PLO PinFit can function as a plug & play lamp and operate with the existing ballast by transferring to 2 pin mode.

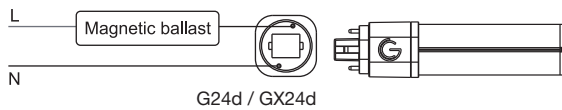

Transfer lamp from 4 pin mode to 2 pin mode

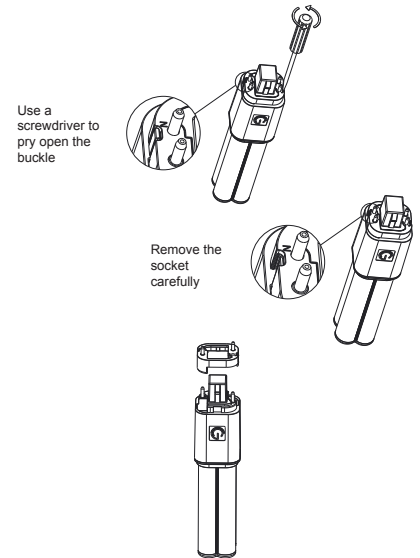

## BYPASS INSTALLATION – NO BALLAST – 2 PIN MODE

If the ballast is not compatible, it can be bypassed and the lamp can run directly off line voltage by transferring to 2 pin mode.

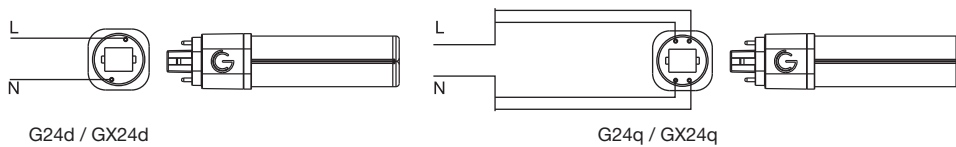

## ACCESSORY ORDERING INFORMATION

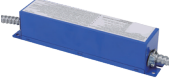
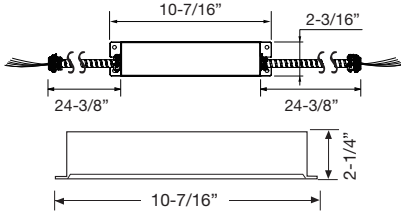
Product	Model	Description	Pictures	Dimensions
98003	23EMDRIVER	California Title 20 Compliant 23W Emergency LED Driver (Field Installation)		

## ORDERING INFORMATION

Model	Master Carton			Shipping Carton		
	Case Qty	Case Dimensions (LxWxH)	Case Weight	Case Qty	Case Dimensions (LxWxH)	Case Weight
6.8PLO/xxx/HYB/PF	6PCS	6-1/8" x 4-3/4" x 3-3/8"	1.43 lb	24PCS	13-3/16" x 10-7/16" x 4-3/4"	6.17 lb
9PLO/xxx/HYB/PF	6PCS	7-1/4" x 4-3/4" x 3-3/8"	1.65 lb	24PCS	15-1/8" x 10-7/16" x 4-3/4"	7.28 lb

## EXTENDED WARRANTIES\*\*\*\*

Model	Description*****
6.8PLO/HYB/PF/10YEARWARRANTY	10 Year warranty for 6.8PLO/8xx/HYB/PF/yy
9PLO/HYB/PF/10YEARWARRANTY	10 Year warranty for 9PLO/8xx/HYB/PF/yy

\*\*\*\* Warranty based on a maximum of 4,368 annual operating hours (per year for ten years) and exposure to a maximum ambient temperature of 80°F / 27°C.

\*\*\*\*\* xx – Refers to the CCT yy – Refers to model generations within the same nominal performance. Typically blank, 'R', or 'RC'.

Note: All rights reserved. All sizes and specifications are subject to change at any time without notice