

**FEATURES**

- Constant output power. Self-testing.
- Long life high temperature recyclable LiFePO4 battery.
- Includes 2-in 1 test switch and charge indicator light.
- 5 year limited warranty.
- Suitable for use in dry and damp location.
- UL Listed for factory or field installation-UL924 & CSAC22.2 NO.141.
- Certified for CA Title 20.

**ELECTRICAL SPECIFICATIONS**

- Input Voltage:100-347Vac,50/60Hz
- Input Power: 12W max
- Input Current: 150mA max
- Output Voltage: 120-190Vdc
- Emergency Output Power: 15W/20W/25W/30W
- Recharge Time: 24 Hours
- Discharge Time: 90 minutes
- Battery: LiFePO4 battery
- Output Current: 300mA max
- Ambient Temp: 5°C to 60°C(41°F to 140°F)

**ORDERING GUIDE**

Model Number	Input Voltage	Output Voltage	Output Power	Application	Discharging Time	Battery Type
BLD-KM15X-190B	100-347V AC, 50/60Hz	120-190Vdc	15W	≤100W(0-10V Dimmable Fixture) ≤15W LED Lamps without dimming function	90 minutes	LiFePO4 battery
BLD-KM20X-190B			20W	≤100W(0-10V Dimmable Fixture) ≤20W LED Lamps without dimming function		
BLD-KM25X-190B			25W	≤150W(0-10V Dimmable Fixture) ≤25W LED Lamps without dimming function		
BLD-KM30X-190B			30W	≤200W(0-10V Dimmable Fixture) ≤30W LED Lamps without dimming function		

**NOTE:** The X represents different construction, can be D or N, D represents models with one Main Enclosure and both ends wiring, N represents models with one Main Enclosure and single end wiring.

**CAUTION:** ① The Emergency LED driver must connect to 0-10V dimming wires(DIM+,DIM-) of the fixture if the LED luminaire power exceeds the emergency LED driver power.  
② When dimming to minimum,the LED luminaire power must be less than emergency driver's power.

**DIMENSIONS**



**15W/20W/25W Driver-15"x2.24"x1.3"**  
(382mmx57mmx33mm)  
Mounting center-14.39"(365.5mm)

**OPTIONAL TEST SWITCH**

**Test Plate:**

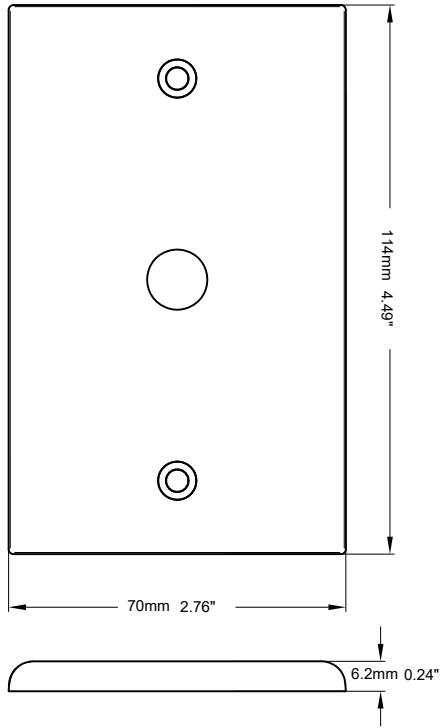

**2 In 1 Plastic Test Switch:**

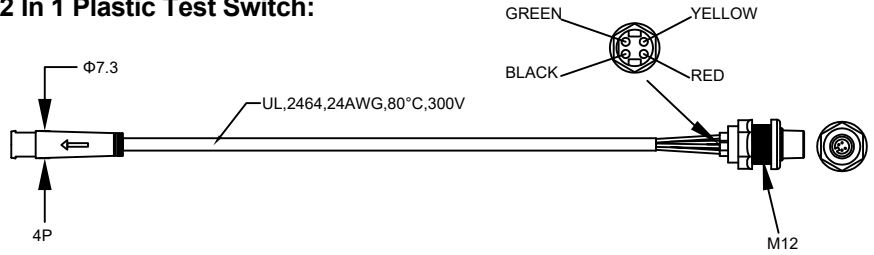

**M12 Metal Test Switch:**

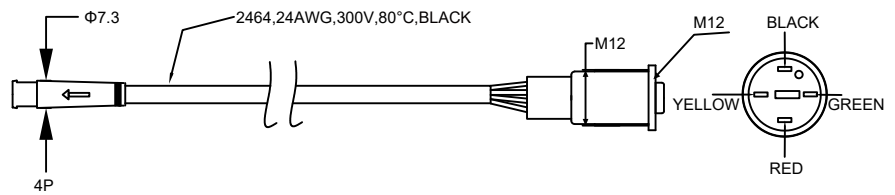

**Skinny Film Test Switch:**

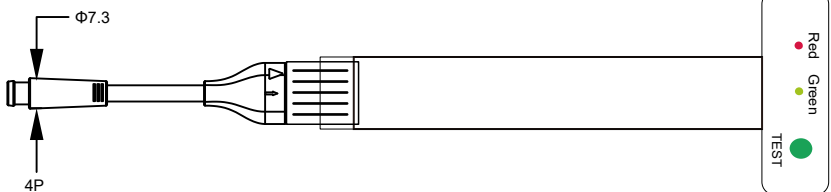

**INSTRUCTION MANUAL**

**IMPORTANT SAFEGUARDS**

When using electrical equipment, basic safety precautions should always be followed including the following:

**READ AND FOLLOW ALL SAFETY INSTRUCTIONS.**

- CAUTION: RISK OF SHOCK-disconnect emergency and normal input power sources before servicing any equipment connected to this unit.
- CAUTION: Risk of fire or electric shock-This emergency battery pack installation requires knowledge of luminaire and electrical systems.
- CAUTION: Servicing of this equipment should be performed by qualified personnel only.
- CAUTION: Before installation, make certain the AC power to fixture is off.
- CAUTION: Verify that all replacement lamp types marked on the installed luminaire are also identified as suitable for use with this emergency battery pack.
- CAUTION: Suitable for use in 5°C to 60°C ambient temperatures. Max. mounting height: 27.2 ft.
- CAUTION: An unswitched AC power source is required (100-347 VAC, 50/60 Hz). This device is designed for fixtures listed for dry and damp locations.
- IMPORTANT: Please charge the battery consistently for >24 hours for the first time usage so as to activate the whole battery cells of discharging/charging duration.
- IMPORTANT: Customers are advised to charge emergency LED drivers 24 hours every 6 months during storage, and which could be stocked for 1 year at most. If customers don't install and recharge for more than one year, the batteries may be damaged. This is not covered in the warranty, and we would charge for replacement.
- IMPORTANT: Lighting fixture manufacturers, electricians, and end-users need to ensure product system compatibility test before using and final installation.
- CAUTION: Do not use outdoors. Do not mount near gas or electric heaters.
- CAUTION: Equipment should be mounted in locations and at heights where it will not be subjected to tampering by unauthorized personnel.
- The use of accessory equipment is not recommended by the manufacturer may cause an unsafe condition.
- The emergency battery pack is not for in an air-handling fixture.
- Do not use this equipment for other than its intended use.

**OPERATION**

**AC Mode:** AC power is present, the LED load from the LED driver is normal power supply, AC LED driver output current can not exceed 4A, the emergency driver is charging in a standby mode.

**Emergency Mode:** When AC power fails, the emergency driver automatically switches to emergency mode, operating the LEDs for a minimum of 90 minutes. When AC power is restored, the emergency driver switches the system back to the normal mode and restores to the battery charging state.

**SELF-TEST:**

This unit contains a control/monitor circuit that if enabled automatically performs a 30-second discharge test once a month and a full 90-minute discharge test once a year. During routine testing, the self-testing emergency driver simulates an AC power failure causing the unit to automatically switch to emergency mode. The unit will monitor the operation of the LED load, and emergency duration. If the emergency system functions properly, then the unit will return to normal mode.



**Indicator Light Introduction**

- ① Red/ON: Charging
- ② Green/ON: Full-charged
- ③ Indicator light OFF: Discharging(emergency mode)
- ④ Green/Flashing: Self-testing
- ⑤ Red Flashing:Error

**Note: See Trouble Shooting Guide**

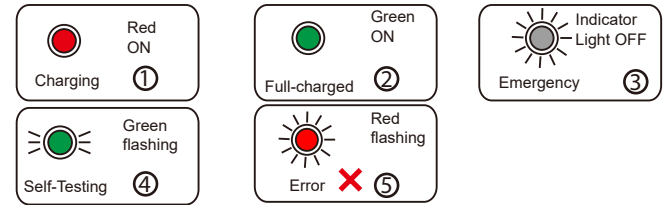

**TEST SWITCH INDICATOR STATUS & TROUBLE SHOOTING GUIDE**

The charge indicator will be lit Solid Red when charging, and will be lit Solid Green when fully charged and in the standby mode. The indicator will flashing Green when self-testing.

Mode	LED Indicators Status	Error	EM Driver Status / Mode	Corrective Action
<b>Normal Mode</b>	Solid Green	None	Battery fully charged/System OK	/
	Solid Red	None	Battery is charging	/
	Both LEDs OFF	None	In EM mode or emergency run-time is ended	/
	Flashing Green	None	Self-Diagnostic test underway	/
<b>Fault Mode</b>	Flashing Red	Overload protection		1. Check load power and connect 2. Check input and dimming line 3. Powered on again 3. Contact after-sales

**MANUAL TEST**

Test Mode	Description	Action	Status	Quit
<b>Fast Test</b>	Quick discharge test	Press the test button 1 time	LED load will light up for 5s	/
<b>Monthly</b>	30 second test	Press the test button 3s continuously	LED load will light up for 30s	Hold the test button/switch for 1s
<b>Annually</b>	90 minute test	Press the test button 6s continuously	LED load will light up for 90 minutes	Hold the test button/switch for 1s

**WIRING DIAGRAM**

**⚠ CAUTION:** Before installing, make certain the AC power is off.

**Wiring 1 : For LED Driver With Input Power Higher Than Emergency Output Power**

0-10V Dimmable LED Driver + Dimmer Switch

Emergency Driver Dim+(Violet/White) , Driver Dim-(Pink/White) Have to connect with LED driver DIM+ and DIM-

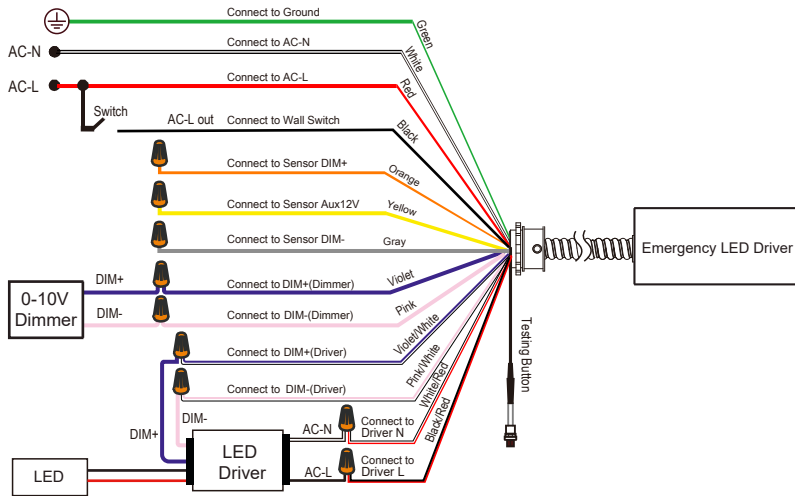

**Wiring 2 : For LED Driver With Input Power Higher Than Emergency Output Power**

0-10V Dimmable LED Driver + Wall Switch

Emergency Driver Dim+(Violet/White) Driver Dim-(Pink/White) Have to connect to LED driver DIM+ and DIM-  
If using 12Vdc sensor, the wires must connect to emergency LED driver's 12V sensor wires.

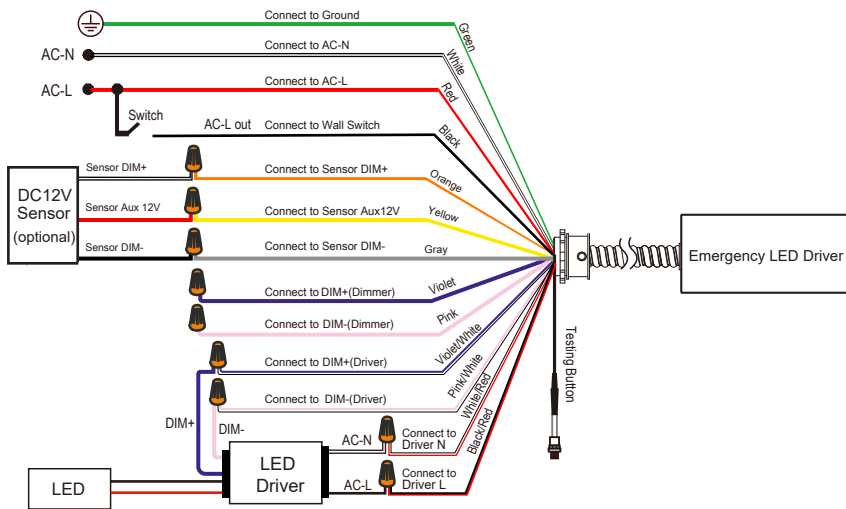

**Wiring 3 : For LED Driver With input Power Less Than Emergency Output Power**

NON Dimmable LED Driver

If using 12Vdc sensor, the wires must connect to emergency LED driver's 12V sensor wires

