

# LED Power Supply

24  
Volt

GEPS12D-60U-GLX2 (120-277 VAC input/12VDC output/60W/0-10V

## Power Supply Features

- Supports all 12 VDC Current LED Products
- Dry and Damp Locations Rated
- UL: Class 2, Class P, Type HL
- IEC: SELV
- 120-277 VAC Input
- Compatible with 0-10V Dimming controller

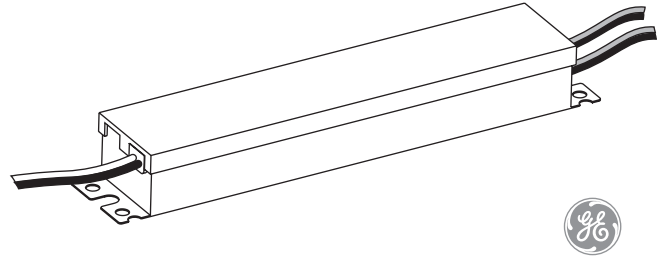

## BEFORE YOU BEGIN

Read these instructions completely and carefully.

<p><b>BG</b> Българската версия на инструкциите за инсталация и информация за безопасност могат да бъдат намерени на следния адрес: <a href="https://www.led.com/eu-en">https://www.led.com/eu-en</a></p> <p><b>CS</b> Návod k montáži a bezpečnostní informace v češtině najdete zde: <a href="https://www.led.com/eu-en">https://www.led.com/eu-en</a></p> <p><b>DA</b> Den danske version af installationsvejledningen og sikkerhedsoplysninger kan findes på følgende placering: <a href="https://www.led.com/eu-en">https://www.led.com/eu-en</a></p> <p><b>DE</b> Die deutsche Version der Installationsanleitung und Sicherheitsinformationen finden Sie in folgendem Verzeichnis: <a href="https://www.led.com/eu-en">https://www.led.com/eu-en</a></p> <p><b>EL</b> Μπορείτε να βρείτε την ελληνική εκδοχή των οδηγιών εγκατάστασης και των πληροφοριών ασφαλείας στην εξής τοποθεσία: <a href="https://www.led.com/eu-en">https://www.led.com/eu-en</a></p> <p><b>ES</b> La versión española de las instrucciones de instalación y la información sobre seguridad puede encontrarse en la siguiente ubicación: <a href="https://www.led.com/eu-en">https://www.led.com/eu-en</a></p> <p><b>ET</b> Eestikeelse paigaldusjuhendi ja ohutusnõuded leiate aadressilt: <a href="https://www.led.com/eu-en">https://www.led.com/eu-en</a></p>	<p><b>FI</b> Asennusohjeiden ja turvallisuuatietojen suomenkielinen versio löytyy seuraavasta paikasta: <a href="https://www.led.com/eu-en">https://www.led.com/eu-en</a></p> <p><b>FR</b> La version française des instructions d'installations et information de sécurité est disponible à l'adresse suivante: <a href="https://www.led.com/eu-en">https://www.led.com/eu-en</a></p> <p><b>HR</b> Hrvatska verzija priručnika za ugradnju i sigurnosnih informacija nalazi se na sljedećoj lokaciji: <a href="https://www.led.com/eu-en">https://www.led.com/eu-en</a></p> <p><b>HU</b> A telepítési útmutató és a biztonság információk magyar nyelvű változata az alábbi címen található: <a href="https://www.led.com/eu-en">https://www.led.com/eu-en</a></p> <p><b>IT</b> La versione italiana del manuale di installazione e sicurezza può essere reperita nella seguente sezione: <a href="https://www.led.com/eu-en">https://www.led.com/eu-en</a></p> <p><b>LT</b> Lietuviška diegimo instrukcijos ir saugos informacijos versija galima rasti šioje vietoje: <a href="https://www.led.com/eu-en">https://www.led.com/eu-en</a></p> <p><b>LV</b> Uzstādīšanas instrukciju un drošības informāciju latviešu valodā var atrast šeit: <a href="https://www.led.com/eu-en">https://www.led.com/eu-en</a></p>	<p><b>NL</b> De Nederlandse versie van de installatie-instructies en veiligheidsinformatie kan op de volgende locatie worden gevonden: <a href="https://www.led.com/eu-en">https://www.led.com/eu-en</a></p> <p><b>PL</b> Polska wersje instrukcji instalacji oraz informacje dotyczące bezpieczeństwa można znaleźć w następującej lokalizacji: <a href="https://www.led.com/eu-en">https://www.led.com/eu-en</a></p> <p><b>PT</b> A versão em Português das instruções de instalação e das informações de segurança pode ser encontrada na seguinte localização: <a href="https://www.led.com/eu-en">https://www.led.com/eu-en</a></p> <p><b>RO</b> Versiunea în limba română a instrucțiunilor de instalare și a informațiilor de siguranță pot fi găsite la: <a href="https://www.led.com/eu-en">https://www.led.com/eu-en</a></p> <p><b>SV</b> Ni hittar den svenska versionen av installationsanvisningarna och säkerhetsinformationen på följande plats: <a href="https://www.led.com/eu-en">https://www.led.com/eu-en</a></p> <p><b>SL</b> Previdnostna opozorila in varnostne informacije so na zadnji strani vodnika za namestitev. Pred začetkom namestitve izdelka jih skrbno preberite: <a href="https://www.led.com/eu-en">https://www.led.com/eu-en</a></p> <p><b>SK</b> Slovenskú verziu montážnej príručky a bezpečnostných instrukcií nájdete na nasledujúcej lokalite: <a href="https://www.led.com/eu-en">https://www.led.com/eu-en</a></p>
---	---	---

For the latest North American install guides for your product go to: <https://www.led.com>  
For the latest European install guides for your product go to: <https://www.led.com/eu-en>

## Prepare Electrical Wiring **FOR UL ONLY**



### Electrical Requirements

- Limited to use in dry and damp locations.
- The suitability of rain enclosure shall be determined if intended for wet location.
- The grounding and bonding of the LED Driver shall be done in accordance with National Electric Code (NEC) Article 600.
- Follow all National Electric Codes (NEC) and local codes.

## Save These Instructions

Use only in the manner intended by the manufacturer. If you have any questions, contact the manufacturer.

## ⚠ CAUTION / ATTENTION

### RISK INJURY

- While performing installations described, gloves, safety glasses or goggles should be worn.

### RISQUES DE BLESSURE

- Lors de l'exécution des installations décrites, des gants, des lunettes de sécurité ou des lunettes de protection doivent être portées.

**⚠ WARNING / AVERTISSEMENT****RISK OF ELECTRIC SHOCK**

- Disconnect power at fuse box or circuit breaker before servicing or installing product.
- Properly ground power supply.
- Use only within an enclosure.
- When utilized within a sign, only the AC input connections need be suitably enclosed.

**RISK OF FIRE**

- Use only approved wire for input/output connection. Minimum size 18 AWG (0.82 mm<sup>2</sup>).
- Follow all local codes.
- Application considerations potentially requiring additional spacing include high ambient temperature seen by the power supply, poor contact with a heat dissipating material, inadequate ventilation, or direct exposure to sun.

**RISQUES DE DÉCHARGES ÉLECTRIQUES**

- Coupez l'alimentation électrique à la boîte de fusibles ou au disjoncteur avant l'entretien ou l'installation du produit.
- Assurez-vous de correctement mettre à terre le bloc d'alimentation.
- Utiliser uniquement dans une enceinte.
- Lorsqu'il est utilisé dans un panneau, seules les connexions d'entrée CA doivent être convenablement fermées.

**RISQUES D'INCENDIE**

- N'utilisez que des fils approuvés pour les entrées/sorties de connexion. Taille minimum 18 AWG (0.82 mm<sup>2</sup>).
- Respectez tous les codes locaux.
- Certaines applications pourraient requérir un espacement additionnel, p. ex. une température ambiante élevée autour du bloc d'alimentation, un mauvais contact avec une matière dissipatrice de chaleur, une ventilation inadéquate ou une exposition directe au soleil.

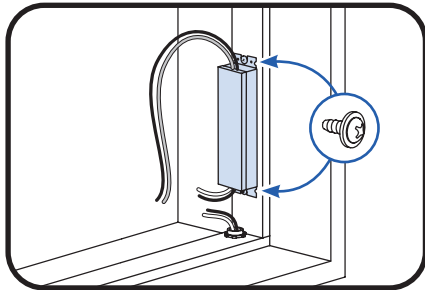
**Power Supply Installation**

- ① Mount the power supply. Mounting the power supply base directly to a thermally conductive installation surface can improve thermal performance. For retrofit applications, place LED driver in the location where the ballast was formerly located.

**NOTE:** All electrical connections should be suitably protected from mechanical damage and the environment. Seal all connections exposed to water with electrical grade self-hardening silicone.

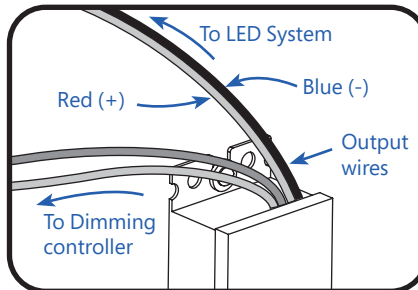

- ② Connect the supply wire that is attached to the LED System to the red (+) and blue (-) output wires of the power supply as outlined in the "**Electrical Connections**" section of your LED system's **Installation Instructions**.

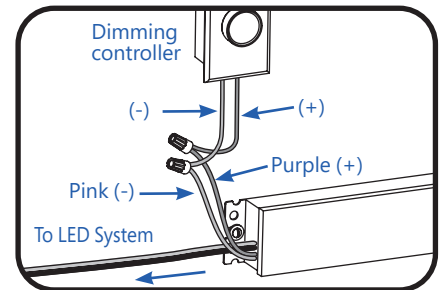

- ③ Connect the (+) purple and (-) pink wires of the Dimming Power Supply to the 0-10V dimming controller. Refer to the dimming controller installation instructions for specific connection information.

**NOTE:** To avoid overloading this power supply with LED modules, please refer to the specific module loading guides.

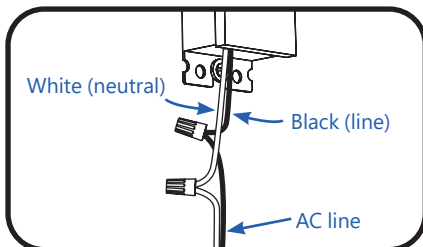

- ④ Connect the AC line to the black (line) and the AC neutral to the white (neutral) input wires of the power supply using suitable wire connectors.

**⚠ WARNING****RISK OF ELECTRIC SHOCK**

AC input connections shall be suitably enclosed.

## Power Supply Specifications

Performance Data	Min	Nominal	Max
Input Voltage (VAC)	108	120-277	305
Input Frequency (Hz)	-	50/60	-
Input Current (A)	-	-	0.6
THD**	-	-	20
PF**	0.95	-	-
Output Voltage (VDC)	11.6	12	12.6
Output Current (ADC)	-	-	5.0
Output Power (W)	-	-	60
Environmental Operating Temperature Range	-40°C	+25°C	+55°C*
Environmental Humidity (non-condensing)	10%	-	90%
Environmental Storage Temperature Range	-40°C	-	+85°C
Environmental Rating	UL Dry and Damp Locations, IP54 rated: must be protected from direct exposure to the weather		
Dimensions	5.83 in. x 1.80 in. x 1.00 in. (148.2 mm x 45.6 mm x 25.4 mm)		

\* Maximum rated case temperature is 90°C . However, the maximum case temperature for warranty is 80°C.

\*\*At 120VAC - 277VAC Full Load

This device complies with part 15 of the FCC Rules. Operation is subject to the following two conditions: (1) This device may not cause harmful interference, and (2) this device must accept any interference received, including interference that may cause undesired operation.

**Note:** This equipment has been tested and found to comply with the limits for a Class A digital device, pursuant to part 15 of the FCC Rules. These limits are designed to provide reasonable protection against harmful interference when the equipment is operated in a commercial environment. This equipment generates, uses, and can radiate radio frequency energy and, if not installed and used in accordance with the instruction manual, may cause harmful interference to radio communications. Operation of this equipment in a residential area is likely to cause harmful interference in which case the user will be required to correct the interference at his own expense.

This Class [A] RFLD complies with the Canadian standard ICES-005. Ce DEFR de la classe [A] est conforme à la NMB-005 du Canada.

Any changes or modifications not expressly approved by the party responsible for compliance could void the user's authority to operate this equipment.

Conforms to the following standards:



Electrical products must not be thrown out with domestic waste. They must be taken to a communal collecting point for environmentally friendly disposal in accordance with local regulations. Contact your local authorities or stockist for advice on recycling. The packaging material is recyclable. Dispose of the packaging in an environmentally friendly manner and make it available for the recyclable material collection-service.

Current Lighting Solutions, LLC  
Cleveland, OH 44124