



KTLD-36-UV-P1200-40-CDIM-MC3

CONSTANT CURRENT PROGRAMMABLE LED DRIVER

DESCRIPTION

LED Driver | 36W | 120-277V Input | 120-1200mA Programmable Output Current

Class P **10 YEAR LIMITED WARRANTY**

TOTAL POWER: 36W	OUTPUT CURRENT: 120-1200mA
INPUT VOLTAGE: 120-277Vac ±10%	DIMMING: 0-10V, Reverse & Forward Phase
INPUT FREQUENCY: 50/60 Hz	WARRANTY: 10 Year Limited

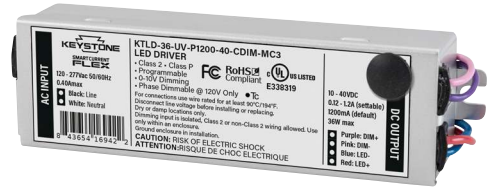

PRODUCT FEATURES

- Micro Case Form Factor, Metal Casing
- 0-10V Dimming, Compliant with ANSI C137.1
- Reverse & Forward Phase Dimmable (120V Only)
- True 1% Dimming over full Output Current Range
- Programmable Output in 1mA Increments
- Programmable Settings via Keystone Programming Kit
- Flicker Free, T24: JA8 & IEE1789 Compliant
- For Indoor Applications
- Class A Sound Rating
- UL Damp Rated

PROGRAMMING FEATURES

- Output Current Set Range: 120-1200mA
- Minimum Output Current: 1.2 mA
- Minimum Dimming Level (1-10%, 0.5% Increments)
- Dimming Curve (Linear, Log, Square)
- Dim to Off (Enable/Disable)
- Thermal Foldback Temperature Selection

WHAT'S NEEDED? The Programmable LED Driver, the Programming Kit, the Connection Cable, and a computer.



PROGRAMMING KIT
USB Programmer
KTLD-P-PGMR-1



Programming Cable
KTLD-P-USB-AUX

ELECTRICAL SPECIFICATIONS

Input Voltage Range	120-277Vac ±10%
Frequency	50/60 Hz
Power Factor	>0.90 at 20-100% Load (Vin @ 120Vac), >0.90 at 40-100% Load (Vin @ 277Vac)
Inrush Current	8.0 A _{peak} , i ² t = 0.017 A ² s @ 120V, 15.8 A _{peak} , i ² t = 0.052 A ² s @ 277V
Max. Input Current	<0.4A (Vin @ 120 Vac), <0.21A (Vin @ 277 Vac)
THD	<20% at 40-100% Load, Vin @ 120-277Vac
Load Regulation	± 5%
Line Regulation	± 1%
Output Tolerance	± 5% at Full Load Condition
Turn-On Delay Time	<0.5 seconds, Cold Start
Overshoot	<10% at Full Load Condition
No Load Power Consumption	<0.5W
Ripple and Noise (pk-pk)	<10%
Withstand Voltage	Input to output, 2,800Vdc, 2mA
Leakage Current	<0.75mA, Vin @ 277VAC, 60Hz
Protection	<ul style="list-style-type: none"> • Over Voltage Protection: Hiccup mode. Protection will trigger when load voltage exceed specified output voltage and will auto recover after the fault mode is removed. • Over Current Protection: Hiccup mode. Protection will trigger when load current exceed specified output current and will auto recover after the fault mode is removed. • Short Circuit Protection: Hiccup mode. Protection will trigger when short circuit and will auto recover after the fault mode is removed. • Over Temperature Protection: Protection will trigger when driver overheat and auto-recovery when cooled down.
Surge Rating	2.5 kV Ring Wave, 2 kV Combination Wave
Dimming Sink Current	200uA



KTLD-36-UV-P1200-40-CDIM-MC3

CONSTANT CURRENT PROGRAMMABLE LED DRIVER

PRODUCT SPECIFICATIONS

Max. Output Power	Output Current	Output Voltage	OCV	Typical Efficiency at 120V	Typical Efficiency at 277V	Remote Mounting Distance (#18 AWG)	Class 2	
							US	Canada
36W	120-1200mA	15-40V	60V	88%	90%	24 ft.	✓	✓

WIRING SPECIFICATIONS

INPUT	8", UL 1430 #18AWG (Black and White)
OUTPUT	8", UL 1430 #18AWG (Red and Blue)
DIMMING	8", UL 1430 #22AWG (Purple and Pink)

PHYSICAL SPECIFICATIONS

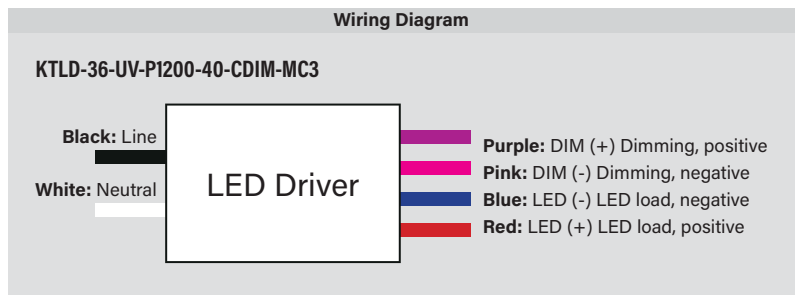
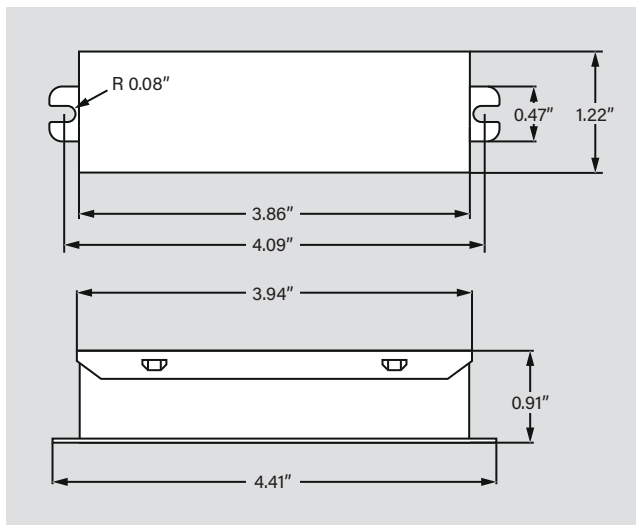

ENVIRONMENTAL SPECIFICATIONS

Operating Temperature	-25°C/-13°F to 50°C/122°F
Storage Temperature	-40°C/-40°F to 85°C/185°F
Humidity	10% to 90% RH
MTBF	>200,000 Hours, Full Load at 25°C/77°F Ambient Temperature
Life Rating	>50,000 Hours, Full Load at 85°C/185°F Case Temperature
Maximum Case Temperature	90°C/194°F
Maximum Case Temperature (tc) for 5-Year Warranty	85°C/185°F

SAFETY AND EMC COMPLIANCE

UL/cUL	UL 8750 Class P CAN/CSA-C22.2 No. 250.13
CE	EN61347-1, EN61347-2-13
FCC, 47CFR Part 15	ANSI C63.4: 2009 - Class B (120Vac Input), Class A (277Vac Input)
EN61000-3-2	Harmonic Current Emissions Class C



KTLD-36-UV-P1200-40-CDIM-MC3

CONSTANT CURRENT PROGRAMMABLE LED DRIVER

LED DRIVER OUTPUT WINDOW

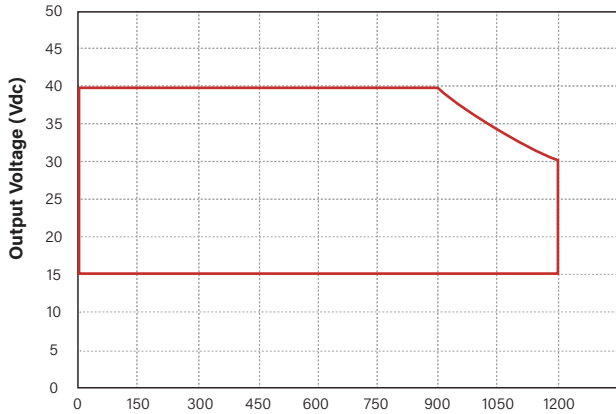

LIFETIME VS CASE TEMPERATURE

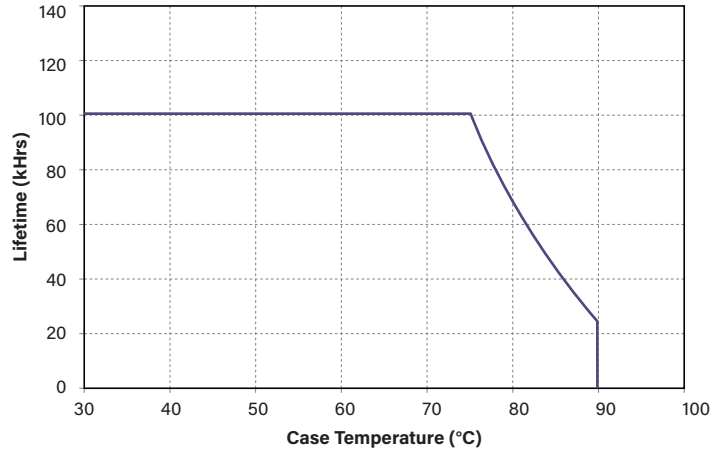

EFFICIENCY (120V)

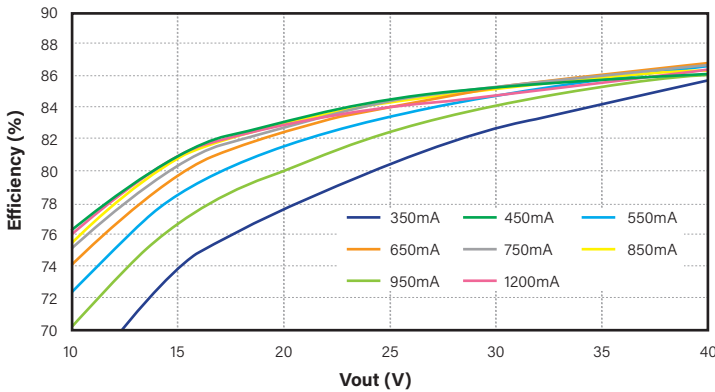

EFFICIENCY (277V)

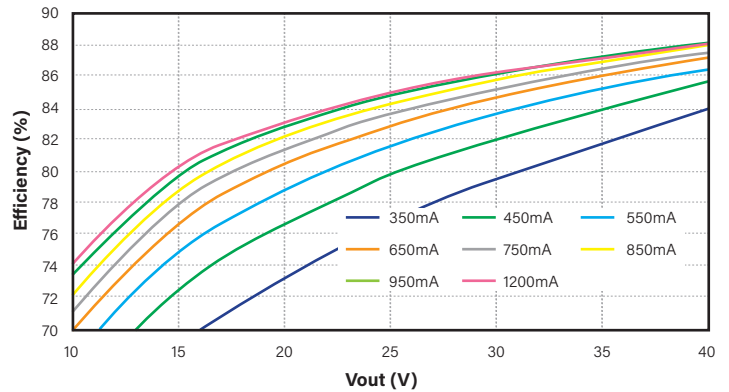

ORDERING INFORMATION

Order Code	Packaging Style	Pack Quantity	Item Status	UPC	EASY CODE
KTLD-36-UV-P1200-40-CDIM-MC3	Carton Pack	80	Quick Ship	843654169422	AGI-84

CATALOG NUMBER BREAKDOWN

KTLD-36-UV-P1200-40-CDIM-MC3

1

2

3

4

5

6

7

8

- 1 Keystone Technologies LED Driver
- 2 Max. Output Wattage
- 3 120-277V Input
- 4 Programmable
- 5 Max. Output Current
- 6 Max. Output Voltage
- 7 Phase & 0-10V Dimming
- 8 Case Style