

PRODUCT SPECIFICATIONS / INFO



2536

UPC Code: 07847755432

Country of Origin: Mexico

Description

Slimline Base, Single Pin, Standard Fluorescent Lampholder, Pedestal, Slide-On Lock-On, Plunger, , Quickwire 18AWG Solid or Str Tinned - White

Color: White

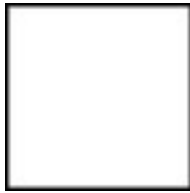

Product Features

Lamp Base: Slimline
 Lamp Contacts: Single Pin
 Style Name: Pedestal
 Mounting Type: Slide-On Lock-On
 Panel Thickness: 20 Ga. Panel
 Contact Type: Plunger
 Termination: Quickwire 18AWG Solid or Str Tinned
 Rated Wattage: 660W
 Color: White
 Standards and Certifications: UL/CSA/NOM
 Warranty: 1 Year Limited
 Availability: Distribution

Electrical Specifications	
Voltage	1000 Volt
Rated Wattage	660W
Mechanical Specifications	
Mounting Type	Slide-On Lock-On
Panel Thickness	20 Ga. Panel
Contact Type	Plunger
Termination	Quickwire 18AWG Solid or Str Tinned
Wire Strip Length	3/8 - 5/8 Inch

Material Specifications	
Body Material	Thermoplastic
Contact Material	Silver-Plated Copper-Alloy
Color	White
Availability	Distribution
Standards and Certifications	
UL Listed	File E5833
UL Rated	Indoor/Outdoor when properly enclosed.
CSA Certified	File LR-1863
NOM Certified	057

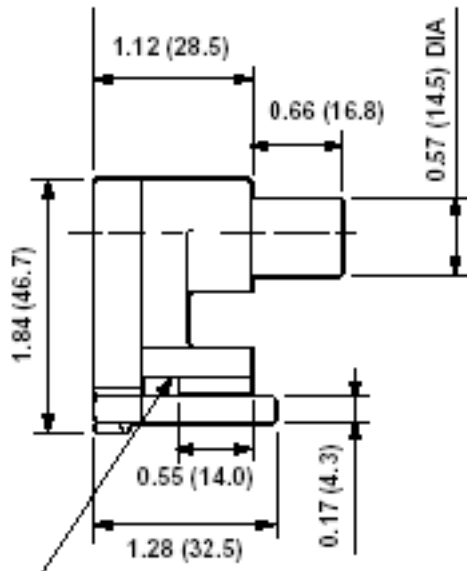

FRONT BODY WITH SPECIAL NOTCHES FOR LOCKING ON 20 GA. PANEL BUMPS

