

B94 Ordering Codes

Philips Emergency Lighting

PHILIPS
bodine

B94GU Type 1 - Universal Input, no conduit

Option 3
Loose ITS Parts Kit

Option 4
Loose Test Switch and
LED Parts Kit

Test Switch
and
LED Kits

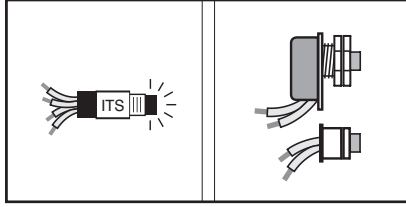

Item # **PDL94GU3M**

Item # **PDL94GU4M**

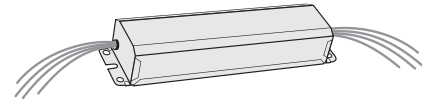

Order Code:
B94GU Type 1
Option _____
Item # _____

B94CGU Type 1 - Universal Input Voltage, with conduit

Option 2
ITS on Wall Plate

Test Switch
and
LED Kit

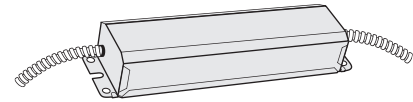
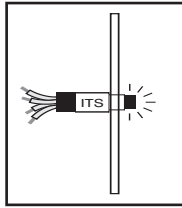

Order Code:
B94CGU Type 1
Option 2
Item # **PDL94G20M**

B94CGU Type 2 - Universal Input Voltage, with conduit, bottom mount

Option 1
Test Switch and
LED on Wall Plate

Test Switch
and
LED Kit

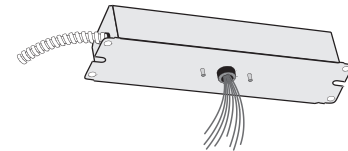
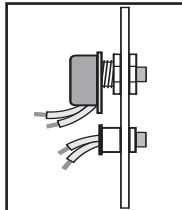

Order Code:
B94CGU Type 2
Option 1
Item # **PDL94G59M**

Non-Universal Input Models with conduit (120/277V)

Option 6B
ITS in Conduit Body

Test Switch
and
LED Kit

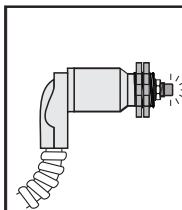

B94CG TYPE 1
Option 6B - Item # **PDL94G50**

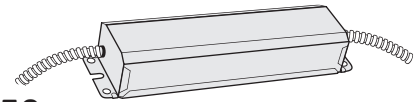

B94CG TYPE 2
Option 6B - Item # **PDL94G39**

