

REVISIONS		
REV	DESCRIPTION	DATE
A1	CHANGED PER ECN 16-017	12/20/2016
A0	RELEASE TO PRODUCTION	07/08/2015

SAFETY STANDARDS COMPLIANCE:
 UL8750
 UL1310

LVD EN61347-2-13
 EMI STANDARDS:
 FCC 47 CFR PART 15 CLASS B
 CE EN55015, EN61547
 EN61000-4-2,3,4,5,6,8,11

SAFETY CERTIFICATIONS
 UL E357847
 cUL E357847
 LVD
 15KWS090064L
 EMC DIRECTIVE
 15KWE092993E

INPUT RANGE:
 110 - 277 VAC, 0.50 - 0.18 A @ FULL LOAD.

FREQUENCY: 50 / 60 Hz. **POWER FACTOR:** >0.9
EFFICIENCY: 85 % Typ. **LEAKAGE CURRENT:**
PEAK INRUSH: 0.66mA Max.
 8 AMPS @ 115V AC
 16 AMPS @ 230V AC

LOAD CAPACITY:	40 WATTS
OUTPUT MIN	1050mA
MAX	23 Volts
LOAD REG	36 Volts
MAX. RIP	±5%
	5%

COOLING: CONVECTION **PROTECTION:**
 NOISE LEVEL: 0 dB OCP,SCP,OLP,OVP
 AUTO-RECOVERY

RELIABILITY (MTBF): (MIL-HDBK-217E)
 100,000 HRS. @ 25 °C @ FULL LOAD

ENVIRONMENTAL CONDITIONS:
 OPERATING TEMPERATURE: -20 ~ 50°C
 RELATIVE HUMIDITY: 5 ~ 95% (NON CONDENSING)
 LOCATION: DRY AND DAMP USE ONLY

CONNECTOR:
 N/A

PF, THD AND EFFICIENCY CALCULATIONS ARE BASED ON THE LOADING OF THE DRIVER TO MINIMUM 65% AND MAXIMUM 100% OF 40W

Notes:

- 1.- 5 yrs warr provided Tc point remains below 75°C
- 2.- Bar code defined by drawing 77-0120.
- 3.- Transformer - Rated Class 130 (B) insulation system
- 4.- Dimming: 0-10V Dimming

SAFETY

INPUT

OUTPUT

MISCELLANEOUS

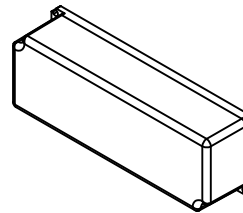
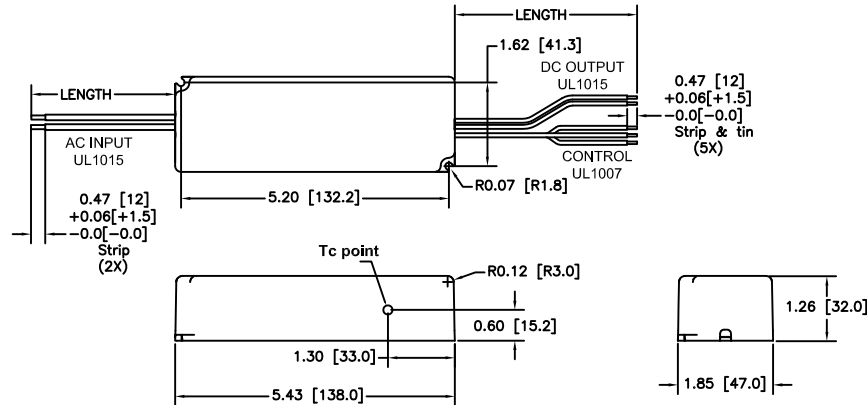

	LED Driver, Isolated, Class 2 output Constant Current, 0~10V Dimmable MODEL: Q38-U36-C1050-XP		DC OUT LED+(RED) LED-(BLACK) DIM+(PURPLE) DIM-(YELLOW) 0-10V
	AC IN AC-N (BLUE) AC-L (BROWN)		

CON	PIN	COLOR	OUTPUT	AWG	LENGTH
AC IN	--	BROWN	LINE	18	6.5 [165] ±0.5 [±13]
	--	BLUE	NEUTRAL	18	
DC OUT	--	RED	+V	18	
	--	BLACK	GND	18	
DIM CNTL	--	YELLOW	+10V OUT	20	
	--	PURPLE	DIM+	20	
	--	GRAY	DIM-	20	

MANUFACTURED BY: ES

THIS ITEM IS THE PROPERTY OF MAGTECH INDUSTRIES AND CONTAINS PROPRIETARY CONFIDENTIAL AND TRADE SECRET INFORMATION. THE INFORMATION CONTAINED HEREIN MUST NOT BE USED, DISCLOSED OR REPRODUCED IN WHOLE OR IN PART WITHOUT PRIOR WRITTEN CONSENT FROM MAGTECH INC.

UNLESS OTHERWISE SPECIFIED DIMENSIONS IN INCHES (MM) TOLERANCES: .X DECIMALS± .05 (1.3) .XX DECIMALS± .02 (0.5) .XXX DECIMALS± .005 (0.13) ANGLES± 1° FRACTIONS± 1/16	QC:	
TITLE: Q38-U36-C1050-XP, 110~277VAC, 1050mA, 23-36V, 5YRS		
DO NOT SCALE THIS DRAWING INTERPRET DRAWING PER ANSI Y14.5M	APPROVAL DATE: 07/15/2015 EFFECTIVE DATE: 07/08/2015	MODEL NO. Q38-U36-C1050-XP DWG NO. M20-5567 REV. A1 SH OF 1 1