

LAMP BASES: GY-9.5, GZ-9.5

2-PIN PREFOCUS
GY-9.5 & GZ-9.5

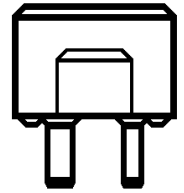

HALOGEN 2 PIN PREFOCUS LAMPHOLDERS



QCJ-11

Note: For 100 watts and greater, ample convection or forced air flow is required to prevent socket damage. Lamp Pins should not exceed 225°C to prevent lamp failure. Consult factory for assistance.

QCJ-11 LEAD OPTION

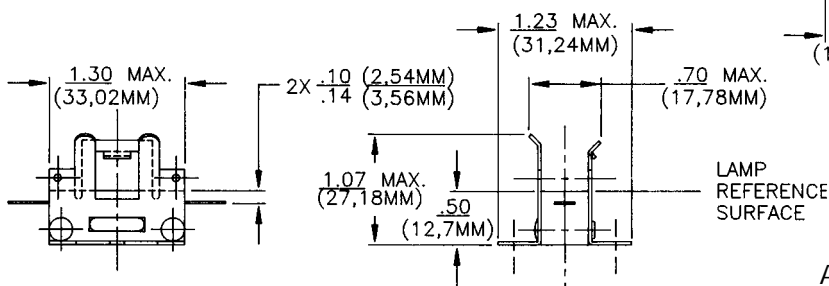

QCJ-11, 11R

The QCJ-11 Lampholder is designed to the ANSI Codes and International Standards. Lampholders are UL and CSA recognized.

QCJ-11 No Ejector

QCJ-11R Right Hand Ejector (Small Lamp Pin Side)

Features:

Ratings:
Volts 300
Amps 10
Watts 750
Temp 200°C

Lead Wire:
Push Lock Terminal
.187 x .020 Inches
Minimum 150°C Rated
Insulation Required
Optional Welded Leads

Construction:
Steatite Body
Silver Plated, Beryllium
Copper Contacts
Stainless Steel Housing

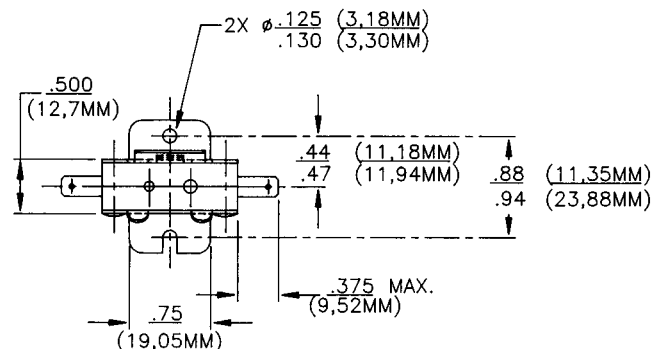

QCJ-11

AVAILABLE WITH RIGHT OR LEFT EJECTOR