

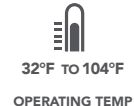

- Lutron compatible control systems.
  - EcoSystem digital control – dims down to 1%
  - 3-wire phase control – dims down to 1%
- 0-10V – dims down to 5%.
- Comes in two different sizes, 17" and 22".
- DALI digital - dims down to 1%.
- Line voltage dimming (LVD) - 5%. 120V only for dimming.
- Retrofit for over 50% less than installing a new fixture.
- Simplest & safest way to achieve energy savings.
- Keep existing fixtures, sensors and control system.
- No mess/fixture recycling. No need to break ceiling plane.
- Substantial maintenance and energy savings.
- Optimize local utility rebates.



ETL CLASSIFIED



Intertek  
5018068

When searching the DLC QPL, use quotation marks around our brand name or Part # ("C-Flex" or "PLL-2.5K-1L-835-3W-M") or visit our website for a file that contains the DLC Product ID.

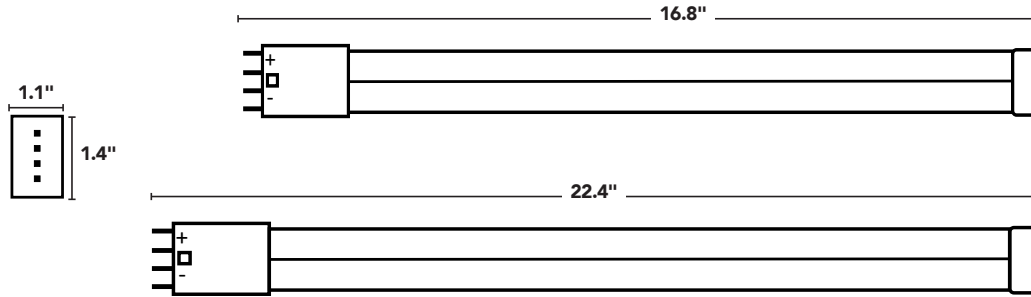

**PART NUMBER BUILDER (SEE CONFIGURATION TABLE ON PG.3 FOR AVAILABLE CONFIGURATIONS BY DRIVER TYPE)**

MFR	TYPE	LUMENS/#OF LAMPS	COLOR	DRIVER	CASE	GEN	OPTIONS
RP	PLL	17" ..... 22" .....	830 = 3000K 835 = 3500K 840 = 4000K	E1 = LUTRON ECO SYSTEM 1DIMS DOWN TO 1%  3W = LUTRON 3 WIRE DIMS DOWN TO 1% (3 LAMP CONFIGURATION NOT AVAILABLE)  10V = 0-10V DIMMING - (PLL KITS WITH M CASE DRIVER REQUIRE WATTAGE OPTION. SEE CONFIGURATION TABLE BELOW FOR SETTINGS) DIMS DOWN TO 5%  LVD = LINE VOLTAGE DIMMING (5% DIMMING TYPICAL. 120V/277V SWITCHED; 120V ONLY FOR DIMMING)	K = SQUARE W/STUDS  KN = SQUARE W/O STUDS  M = LINEAR  (SEE DIMENSIONS ON PG. 5)	G2	-EMG -W -B  SEE TABLE BELOW

**EXAMPLE PART NUMBER** PLL-2.5K-1L-835-3W-M-G2-EMG

**OPTIONS**

EMG	W	B
<b>EMERGENCY BATTERY BACKUP</b> (See page 3 for more details)	<b>SPECIFIC WATTAGE</b> (Only required with 0-10V M-case driver option See below for wattage and lumen options)	<b>BULK PACK OPTIONS</b> B24 = 1-lamp kit B12 = 2-lamp kit B8 = 3-lamp kit B6 = 4-lamp kit



# PLL/BIAX PIN-BASED LAMP LED RETROFIT KIT



COMMON DRIVER/EMG CONFIGURATIONS (SEE PG. 4)

E1 DRIVER	PART #	LAMP LENGTH	LAMPS PER DRIVER	SYSTEM WATTAGE	SYSTEM LUMENS	EMG [SEE PG. 4 FOR CONFIGURATIONS]
	RP-PLL-2.0K-1L-8XX-E1-C-G2	17"	1 LAMP	20	2000	CONFIGURATION A
	RP-PLL-4.0K-2L-8XX-E1-C-G2		2 LAMPS	40	4000	CONFIGURATION B
	RP-PLL-6.0K-3L-8XX-E1-C-G2		3 LAMPS	60	6000	CONFIGURATION C
	RP-PLL-2.5K-1L-8XX-E1-C-G2	22"	1 LAMP	25	2500	CONFIGURATION A
	RP-PLL-5.0K-2L-8XX-E1-C-G2		2 LAMPS	50	5000	CONFIGURATION B
RP-PLL-7.5K-3L-8XX-E1-C-G2	3 LAMPS		75	7500	CONFIGURATION C	

3W DRIVER	PART #	LAMP LENGTH	LAMPS PER DRIVER	SYSTEM WATTAGE	SYSTEM LUMENS	EMG [SEE PG.4 FOR CONFIGURATIONS]
	RP-PLL-2.0K-1L-8XX-3W-C-G2	17"	1 LAMP	20	2000	CONFIGURATION A
	RP-PLL-4.0K-2L-8XX-3W-C-G2		2 LAMPS	40	4000	CONFIGURATION B
	RP-PLL-2.5K-1L-8XX-3W-C-G2	22"	1 LAMP	25	2500	CONFIGURATION A
RP-PLL-5.0K-2L-8XX-3W-C-G2	2 LAMPS		50	5000	CONFIGURATION B	

LVD DRIVER	PART #	LAMP LENGTH	LAMPS PER DRIVER	SYSTEM WATTAGE	SYSTEM LUMENS	EMG [SEE PG. 4 FOR CONFIGURATIONS]
	RP-PLL-4.0K-2L-8XX-LVD-M-G2	17"	2 LAMPS	40	4000	CONFIGURATION B
	RP-PLL-4.0K-2L-8XX-LVD-K-G2		2 LAMPS	40	4000	CONFIGURATION B
	RP-PLL-2.0K-1L-8XX-LVD-KN-G2		1 LAMP	20	2000	CONFIGURATION A
	RP-PLL-4.0K-2L-8XX-LVD-KN-G2		2 LAMPS	40	4000	CONFIGURATION B
	RP-PLL-6.0K-3L-8XX-LVD-KN-G2		3 LAMPS	60	6000	CONFIGURATION C
	RP-PLL-2.5K-1L-8XX-LVD-M-G2	22"	1 LAMP	25	2500	CONFIGURATION A
	RP-PLL-2.5K-1L-8XX-LVD-K-G2		1 LAMP	25	2500	CONFIGURATION A
	RP-PLL-2.5K-1L-8XX-LVD-KN-G2		1 LAMP	25	2500	CONFIGURATION A
	RP-PLL-5.0K-2L-8XX-LVD-KN-G2		2 LAMPS	50	5000	CONFIGURATION B
RP-PLL-7.5K-3L-8XX-LVD-KN-G2	3 LAMPS		68	6800	CONFIGURATION C	

10V DRIVER	PART #	LAMP LENGTH	LAMPS PER DRIVER	SYSTEM WATTAGE	SYSTEM LUMENS	EMG [SEE PG. 4 FOR CONFIGURATIONS]
	RP-PLL-2.0K-1L-8XX-10V-M-G2-18W	17"	1 LAMP	18	1800	CONFIGURATION A
	RP-PLL-4.0K-2L-8XX-10V-M-G2-35W		2 LAMPS	35	3500	CONFIGURATION B
	RP-PLL-6.0K-3L-8XX-10V-M-G2-50W		3 LAMPS	50	5000	CONFIGURATION B
	RP-PLL-2.0K-1L-8XX-10V-K-G2		1 LAMP	18	1800	CONFIGURATION A
	RP-PLL-4.0K-2L-8XX-10V-K-G2		2 LAMPS	36	3600	CONFIGURATION B
	RP-PLL-6.0K-3L-8XX-10V-K-G2		3 LAMPS	52	5200	CONFIGURATION B
	RP-PLL-2.0K-1L-8XX-10V-KN-G2		1 LAMP	18	1800	CONFIGURATION A
	RP-PLL-4.0K-2L-8XX-10V-KN-G2		2 LAMPS	36	3600	CONFIGURATION B
	RP-PLL-6.0K-3L-8XX-10V-KN-G2		3 LAMPS	52	5200	CONFIGURATION B
	RP-PLL-2.5K-1L-8XX-10V-M-G2-20W	22"	1 LAMP	20	2000	CONFIGURATION A
	RP-PLL-5.0K-2L-8XX-10V-M-G2-40W		2 LAMPS	40	4000	CONFIGURATION B
	RP-PLL-7.5K-3L-8XX-10V-M-G2-60W		3 LAMPS	60	6000	CONFIGURATION C
	RP-PLL-2.5K-1L-8XX-10V-K-G2		1 LAMP	25	2500	CONFIGURATION A
	RP-PLL-5.0K-2L-8XX-10V-K-G2		2 LAMPS	50	5000	CONFIGURATION B
	RP-PLL-7.5K-3L-8XX-10V-K-G2		3 LAMPS	64	6400	CONFIGURATION C
	RP-PLL-2.5K-1L-8XX-10V-KN-G2		1 LAMP	25	2500	CONFIGURATION A
	RP-PLL-5.0K-2L-8XX-10V-KN-G2		2 LAMPS	50	5000	CONFIGURATION B
	RP-PLL-7.5K-3L-8XX-10V-KN-G2		3 LAMPS	64	6400	CONFIGURATION C



## EMG CONFIGURATIONS

### 4W ALL IN ONE EMG [CONFIGURATION A]

EXISTING PLL LAMPS WILL LIGHT IN EMG MODE  
Approximately 500 lumens for 90 minutes.  
Contact us for more options

#### DRIVER



EMG DIMENSIONS: 5.34" x 1.69" x 1.01"  
(SEE LINE DRAWING BELOW)  
SEE EXAMPLE 1 BELOW FOR WIRING DIGRAM

### 4W ALL IN ONE EMG W/ SEPARATE LIGHT ENGINE [CONFIGURATION B]

SEPARATE LIGHT ENGINE WILL LIGHT IN EMG MODE  
Approximately 500 lumens for 90 minutes.  
Contact us for more options

#### DRIVER



#### LIGHT ENGINE



EMG DIMENSIONS: 5.34" x 1.69" x 1.01"  
(SEE LINE DRAWING BELOW)  
LIGHT ENGINE DIMENSIONS: 4.7 x .83" x .04"  
SEE EXAMPLE 1 BELOW FOR WIRING DIGRAM

### 8W EMG DRIVER, SEPARATE BATTERY & LIGHT ENGINE [CONFIGURATION C]

SEPARATE LIGHT ENGINE WILL LIGHT IN EMG MODE  
Approximately 1000 lumens for 90 minutes.  
Contact us for more options

#### DRIVER + LIGHT ENGINE



EMG DIMENSIONS: 5.34" x 1.69" x 1.01"  
(SEE LINE DRAWING BELOW)  
LIGHT ENGINE DIMENSIONS: 4.7 x .83" x .04"  
BATTERY DIMENSIONS: 3.48" x 2.76" x .99"  
(SEE LINE DRAWING BELOW)

## EMG LINE DRAWING

USED FOR ALL EMG KITS

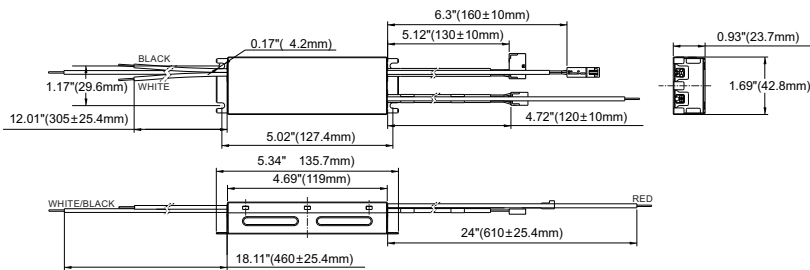

## EXTERNAL BATTERY

USED FOR RP-EM-SKB-1000LM/90-4.7X.8-8W

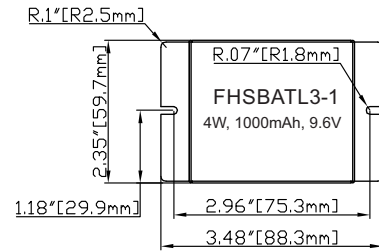

## WIRING DIAGRAMS

### FOR CONFIGURATION A

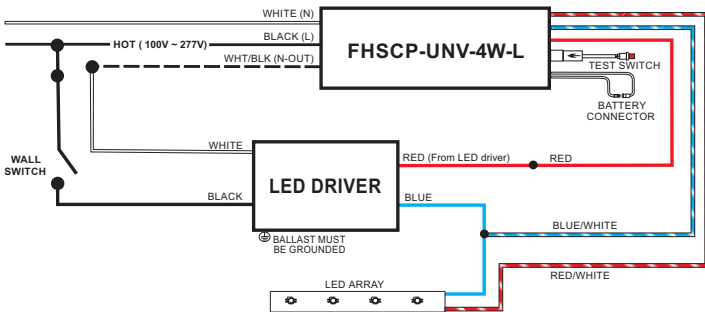

### FOR CONFIGURATION B & C

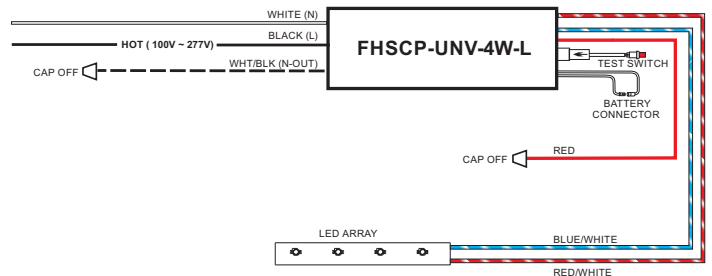

# C-Flex PLL/BIAX PIN-BASED LAMP LED RETROFIT KIT



## DRIVER DIMENSIONS

### LUTRON

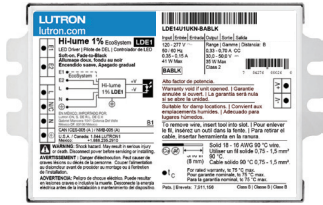

CASE TYPE K

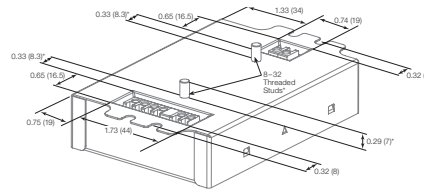

K CASE CONNECTOR LOCATIONS (WITH STUDS)

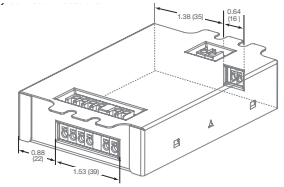

KN CASE SIDE ENTRY CONNECTOR LOCATIONS (WITHOUT STUDS)



CASE TYPE M

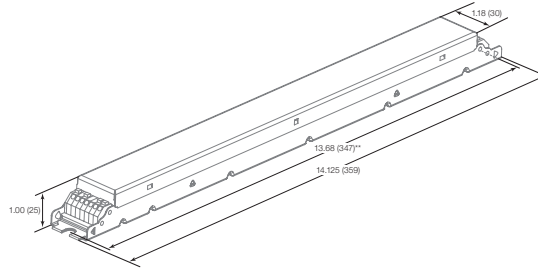

### LVD

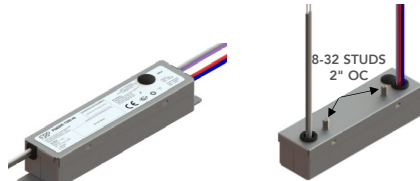

M CASE

K CASE

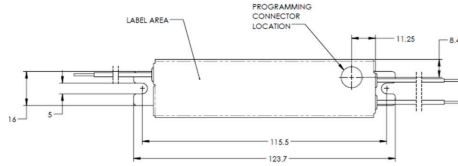

M CASE

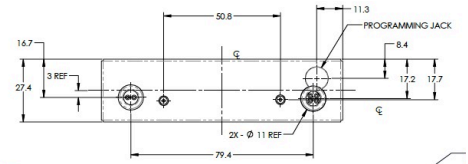

K CASE



KN CASE  
25W SYSTEM MAX

KN CASE  
26 TO 60W SYSTEM MAX

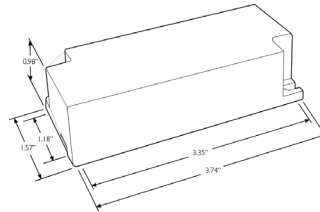

KN CASE 25W SYSTEM MAX

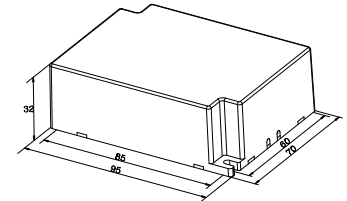

KN CASE 26W TO 60W SYSTEM WATTAGE

**NOTE** It is important that LVD drivers are mounted to a flat metal surface in order to maximize service life.

### 10V

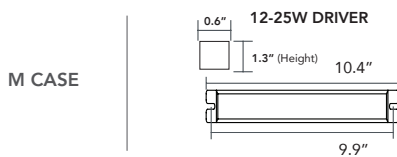

M CASE

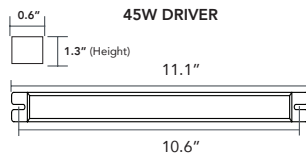

KN CASE

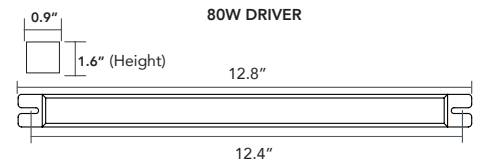

K CASE

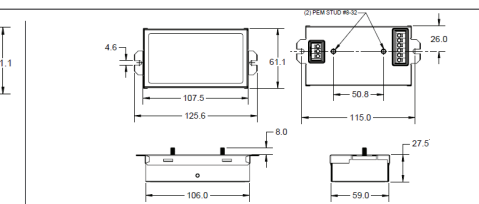
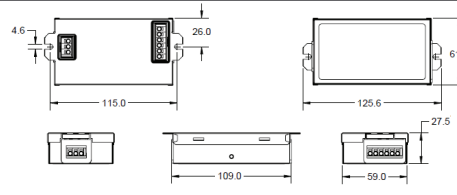



# PLL/BIAX PIN-BASED LAMP LED RETROFIT KIT



## MOST COMMON FIXTURE TYPES



**CEILING/TROFFER**  
2-LAMP DOWNLIGHT ORIENTATION



**PENDANT**  
1 OR 2-LAMP UPLIGHT/DOWNLIGHT ORIENTATION



**SCONCE**  
1 OR 2-LAMP VERTICAL ORIENTATION



FOR MORE INFORMATION VISIT [C-FLEXRETROFITS.COM](http://C-FLEXRETROFITS.COM)