



T5 Circular

55W/830 C-T5 1CT

Philips T5 Circular lamps are ultra-slim with improved color rendering, higher efficacy, and longer life. T5 HO circular lamps offer extraordinary light output.

Product data

• General Characteristics

Base	2GX13
Bulb	C-T5 [C-T 16 mm]
Life to 10% fail Preheat EL,3h	8000 hr
Rated Avg. Life	12000 hr
LSF HF Preheat	99 %
2000h Rated,3h	
LSF HF Preheat	99 %
4000h Rated,3h	
LSF HF Preheat	96 %
6000h Rated,3h	
LSF HF Preheat	89 %
8000h Rated,3h	
LSF HF Preheat	50 %
12000h Rated,3h	
LSF HF Preheat	10 %
16000h Rated,3h	
LSF HF Preheat	1 %
20000h Rated,3h	

• Light Technical Characteristics

Color Code	830 [CCT of 3000K]
Color Rendering Index	80 (min), 85 (nom), 85 (max) Ra8
Color Designation	Warm White
Color Temperature	3000 K
Luminous Flux EL	4200 Lm
25°C, Rated	
Luminous Flux EL	4200 Lm
25°C, Nominal	
Lum Efficacy Rated	76 Lm/W
HF 25°C	
LLMF HF 2000h	91 %
Rated	

LLMF HF 4000h	87 %
Rated	
LLMF HF 6000h	84 %
Rated	
LLMF HF 8000h	81 %
Rated	
LLMF HF 12000h	77 %
Rated	
LLMF HF 16000h	74 %
Rated	
LLMF HF 20000h	72 %
Rated	
Design Temperature	35 C
Chromaticity Coordinate X	440 -
Chromaticity Coordinate Y	403 -

• Electrical Characteristics

Watts	55 W
Lamp Wattage EL	55.0 W
25°C, Rated	
Lamp Wattage EL	55 W
25°C, Nominal	
Lamp Voltage EL	101 V
25°C	
Lamp Current EL	0.550 A
25°C	
Dimmable	Yes

• Environmental Characteristics

Energy Efficiency Label (EEL)	A
Mercury (Hg) Content	2.5 mg

PHILIPS

T5 Circular

Energy consumption 61 kWh
kWh/1000h

• **Measuring Conditions**

Calibration Current 0.550 A
HF Generator Rated Voltage 202 V
Resistor 185 ohm

• **Product Dimensions**

Diameter D 14 (min), 18 (max) mm
Overall Width E 293 (min), 305 (max) mm
Inner Width I 260 (min), 272 (max) mm

• **Product Data**

Product number 165936
Full product name MASTER TL5 Circular 55W/830 1CT
Short product name MASTER TL5 Circular 55W/830 1CT/10
Pieces per Sku 1
eop_pck_cfg 10
Skus/Case 10
Bar code on pack 8711500642790
Bar code on case 8711500642806
Logistics code(s) 927965783013
tpd_ilcos_cd FSCH-55/30/1B-L/P-2GX13-16
eop_net_weight_pp 82.000 gr

Dimensional drawing

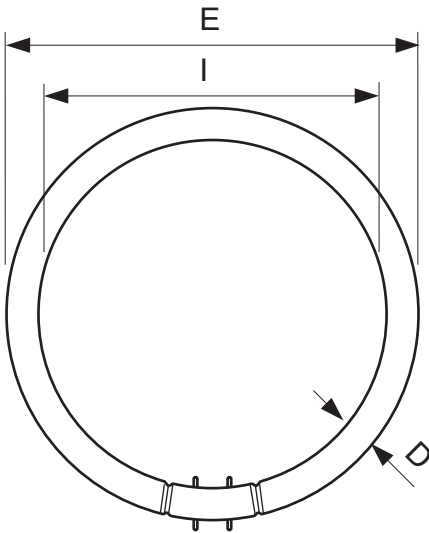

55W/830 C-T5 1CT

Product	D (Min)	D (Max)	E (Min)	E (Max)	I (Min)	I (Max)
TL5-C 55W/830	14	18	293	305	260	272

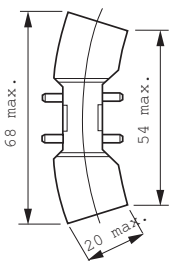

2GX13

Photometric data

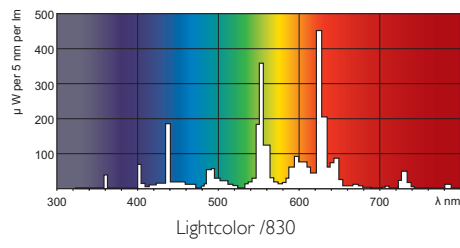
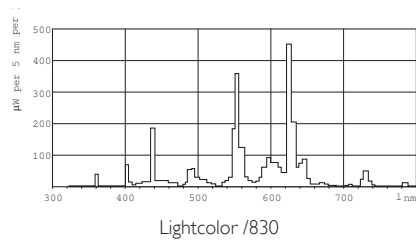

© 2014 Koninklijke Philips N.V. (Royal Philips)
All rights reserved.

Specifications are subject to change without notice. Trademarks are the property of Koninklijke Philips N.V. (Royal Philips) or their respective owners.

www.philips.com/lighting

2014, October 31
data subject to change